



THE SUTHERLAND ROOM

The versatile Sutherland Room always looks impressive, whether prepared for a high-level board meeting, set for a lavish breakfast or for an exclusive private dinner.

The Sutherland Room, conveniently located to the rear of The Game Bird, can be used semi-privately for a casual lunch or dinner or privately for a more formal evening or meeting. The Sutherland Room is combined with The Panel Room, which can be used for pre-dinner drinks or as a break-out room for meetings.

HIGHLIGHTS

- Can be hired semi-privately or privately
- Linked with The Panel Room
- Selection of meeting and private dining packages
- Bespoke menus from The Game Bird

KEY FACTS

Dimensions: 9.63m x 4.47m / 31.6 x 14.7ft
 Total Area: 48 m² / 517 ft²
 Ceiling height: 2.54m
 Adjoining Room: The Panel Room / The Game Bird
 Location: Ground floor

LAYOUT	CAPACITY
Oval Table	26
Round Table	24 (3X8)
U-Shape	22
Boardroom	26
Theatre	40
Cabaret	18 (3X6)
Classroom	24
Standing	40
E-Shape	29

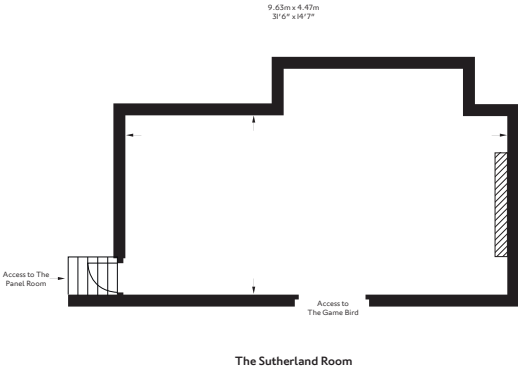

THE SUTHERLAND ROOM ALTERNATIVE LAYOUT OPTIONS



Theatre layout - up to 40 guests



Reception - up to 60 guests with
The Panel room



Oval layout - up to 26 guests or
24 guests with plasma screen

thestaffordlondon.com

[@StaffordLondon](#) [f TheStaffordLondon](#) [thestaffordlondon](#)

16-18 St James's Place London SW1A 1NJ United Kingdom

T +44 (0)20 7518 1104 E meetingsandevents@thestaffordlondon.com

LEGEND™
Preferred
HOTELS & RESORTS